



# ZF817-12

Supplied By: **TRENCH DRAIN SUPPLY** 877-903-7246  
www.trenchdrainsupply.com

## 12 [305] x 24 [610] LONG REVEAL FIBER REINFORCED POLYMER CATCH BASIN

TAG \_\_\_\_\_

Dimensional Data (inches and [ mm ]) are Subject to Manufacturing Tolerances and Change Without Notice

SPECIFYING ENGINEER IS RESPONSIBLE  
FOR CONCRETE ENCASEMENT AND  
REINFORCING BASED UPON APPLICATION  
AND LOCAL CODES.

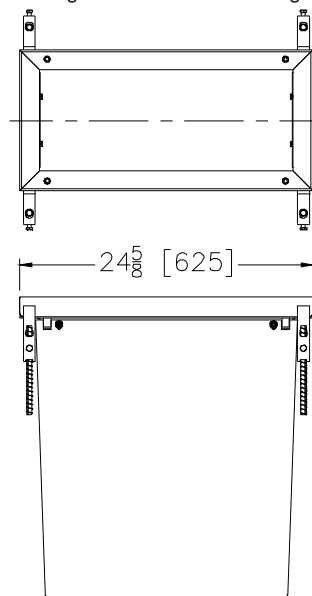
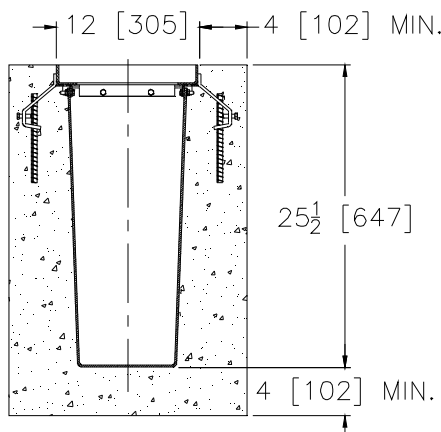

NOTE: +Actual Frame length is 24<sup>5</sup>/<sub>8</sub> [625].

### ENGINEERING SPECIFICATION: Zurn ZF817-12

Catch Basin is 12 [305] wide, 24-5/8 [625] long reveal and 25-1/2 [647] deep. The body is made of 0% water absorbent Fiber Reinforced Polyester (FRP) fiberglass. Catch basin weighs less than 14.6 lbs. [6.6 kg] per linear foot, and is provided with standard DGC grate. Zurn 12 [305] wide reveal Ductile Iron Slotted Grate conforming to ASTM specification A536, Grade 80-55-06. Ductile Iron grate is rated class C per the DIN EN1433 top load classifications. Supplied in 24 [608] nominal lengths with 13/16 [21] wide slots, and 1-1/2 [38] bearing depth. Grate has an open area of 80.8sq. in. per ft. [171,027 sq. mm per meter]. The #7 gage thick Heavy-Duty Frame Assembly conforms to ASTM specification A36. Frame shall mechanically lock into concrete surround at a maximum spacing of 23 [584] with four rebar attachment brackets as standard to secure the basin in its final location. The frame is supplied with a powder coated finish. All welds must be performed by a certified welder per ASTM standard AWS D1.1. Frame and basin shall be produced in the U.S.A.

### PREFIX OPTIONS (Check/specify appropriate options)

\_\_\_ ZF 12-inch by 24-inch Fiber Reinforced Polymer (FRP)\*

### SUFFIX OPTIONS (Check/specify appropriate options)

#### Outlet Adapters Add/Each

\_\_\_ -E4 4 [102] No-Hub End Outlet      \_\_\_ -U4 4 [102] No-Hub Bottom Outlet  
\_\_\_ -E6 6 [152] No-Hub End Outlet      \_\_\_ -U6 6 [152] No-Hub Bottom Outlet  
\_\_\_ -E8 8 [204] No-Hub End Outlet      \_\_\_ -U8 8 [204] No-Hub Bottom Outlet

#### Grate Options (Load Classifications are per DIN EN1433)

\_\_\_ -BDC Black Acid Resistant Epoxy Coated Ductile Grate - Class C  
\_\_\_ -BDE Black Acid Resistant Epoxy Coated Ductile Grate - Class E  
\_\_\_ -BG Galvanized Ductile Iron Bar Grate - Class D  
\_\_\_ -DC Ductile Iron Solid Cover - Class C  
\_\_\_ -DGC Ductile Iron Slotted Grate - Class C \*  
\_\_\_ -DGE Ductile Iron Slotted Grate - Class E  
\_\_\_ -DGF Ductile Iron Slotted Grate - Class F  
\_\_\_ -GDC Galvanized Ductile Slotted Grate - Class C  
\_\_\_ -GDE Galvanized Ductile Slotted Grate - Class E  
\_\_\_ -GDF Galvanized Ductile Slotted Grate - Class F  
\_\_\_ -GHPD Galvanized Heel-Proof Ductile Grate - Class C  
\_\_\_ -GHPDE Galvanized Heel-Proof Ductile Slotted Grate - Class E  
\_\_\_ -HPD Heel-Proof Ductile Slotted Grate - Class C

\_\_\_ -HPDE Heel-Proof Ductile Slotted Grate - Class E  
\_\_\_ -RFGC Reinforced Slotted Galvanized Grate - Class C  
\_\_\_ -RPGC Reinforced Perforated Galvanized Grate - Class C  
\_\_\_ -RPGRC Reinforced Perforated Galvanized Reverse Punch Grate - Class C  
\_\_\_ -RFSC Reinforced Slotted Stainless Steel Grate - Class C  
\_\_\_ -RPSC Reinforced Perforated Stainless Steel Grate - Class C  
\_\_\_ -RPSRC Reinforced Perforated Stainless Steel Reverse Punch Grate - Class C

#### Miscellaneous Options

\_\_\_ -IA Inlet Adapter - Z806  
\_\_\_ -IA Inlet Adapter - Z812

### MADE in the U.S.A. (Load Classifications are per DIN EN1433)

\_\_\_ -ADA-USA Meets Americans with Disabilities Act Requirements - Class C  
\_\_\_ -DGC-USA Ductile Iron Slotted Grate - Class C  
\_\_\_ -DGE-USA Ductile Iron Slotted Grate - Class E  
\_\_\_ -FG Fabricated Galvanized Steel Slotted Grate - Class A  
\_\_\_ -FS Fabricated Stainless Steel Slotted Grate - Class A  
\_\_\_ -GADA-USA Galvanized Ductile ADA Slotted Grate - Class C  
\_\_\_ -GDC-USA Galvanized Ductile Slotted Grate - Class C  
\_\_\_ -GDE-USA Galvanized Ductile Slotted Grate - Class E  
\_\_\_ -GHPDE-USA Galvanized Heel-Proof Ductile Slotted Grate - Class E  
\_\_\_ -HPDE-USA Heel-Proof Ductile Slotted Grate - Class E  
\_\_\_ -PG Perforated Galvanized Steel Grate - Class A

\_\_\_ -PS Perforated Stainless Steel Grate - Class A  
\_\_\_ -SBG-L Stainless Steel Bar Grate - Class C

#### Miscellaneous Options

\_\_\_ -DB Bottom Dome Strainer  
\_\_\_ -FT Foul Air Trap  
\_\_\_ -VP Vandal-Proof Lockdown  
\_\_\_ -Y Sediment Bucket

\*REGULARLY FURNISHED UNLESS OTHERWISE SPECIFIED

REV. F      DATE: 03/25/13      C.N. NO. 129008  
PROD/DWG. NO. ZF817-12

ZURN INDUSTRIES, LLC ♦ SPECIFICATION DRAINAGE OPERATION ♦ 1801 Pittsburgh Ave. ♦ Erie, PA 16514

Phone: 814/455-0921 ♦ Fax: 814/454-7929 ♦ World Wide Web: www.zurn.com

In Canada: ZURN INDUSTRIES LIMITED ♦ 3544 Nashua Drive ♦ Mississauga, Ontario L4V1L2 ♦ Phone: 905/405-8272 Fax: 905/405-1292